

# 12/30 Int Slipform Passenger Hoist

**CAPITAL**  
HOIST

Alimak 12/30 Int Passenger Goods Hoist	
Capacity	1200kg per cage
Personnel	12 per cage
Internal Cage Dimensions L x W x H	3000 x 1300 x 2550
Cage Gate Opening H x W	2000 x 1232
Landing Gate Opening H x W	2015 x 1500
Base Unit Weight Single	2300kg
Base Unit Weight Twin	3555kg
Motor Drive Unit	2 x 9.5kW per cage
Power Fuse Supply (3-Phase)	63A per cage
Starting Current	200A per cage
Maximum Mast Height	150m
Max Tie Spacing	12m

Tel 01322 339 353

[www.capitalhoists.co.uk](http://www.capitalhoists.co.uk)

[Info@caphoist.co.uk](mailto:Info@caphoist.co.uk)

17 Maypole Crescent  
Darent Industrial Park  
Erith  
Kent  
DA8 2JZ

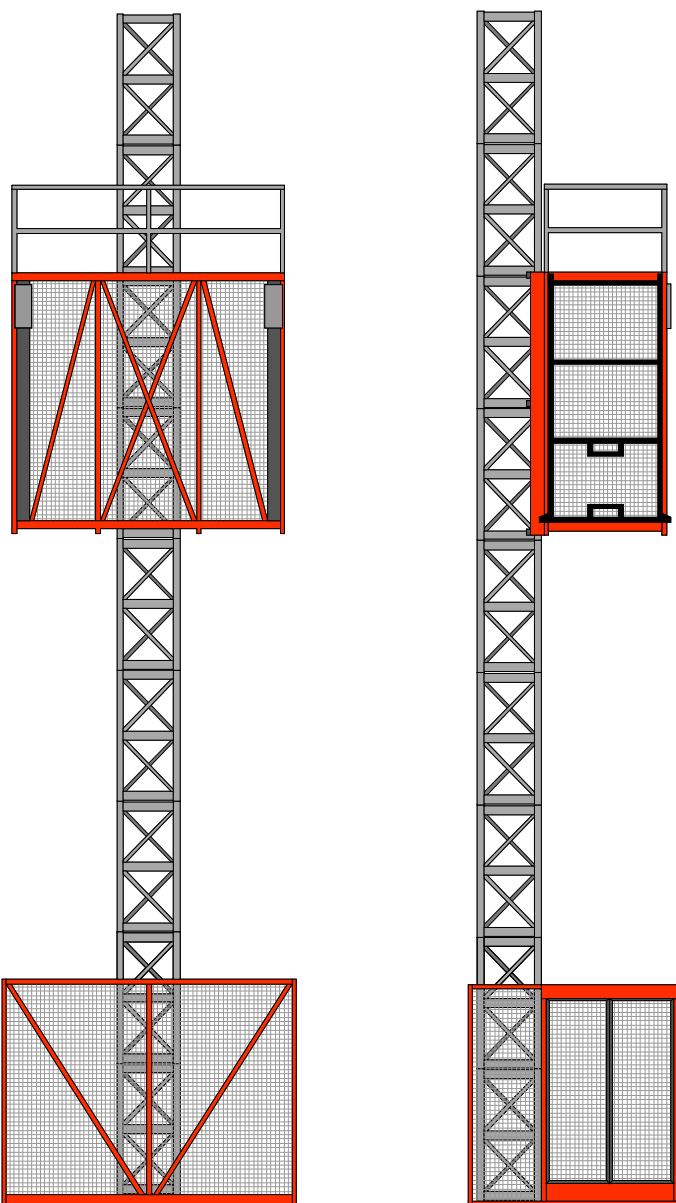
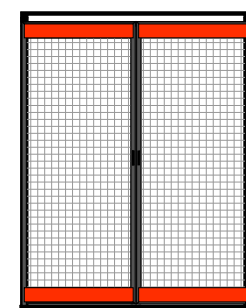

Landing Gates are installed  
on the slipform rig

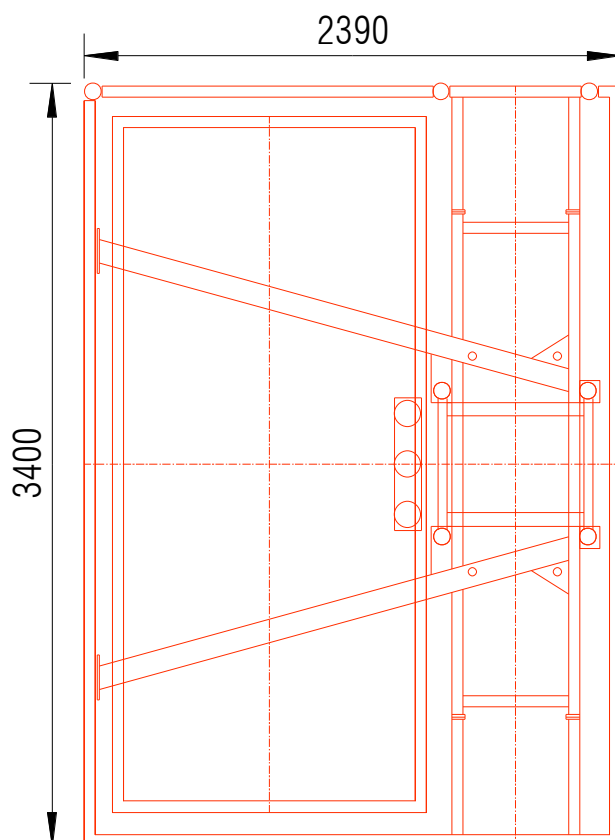

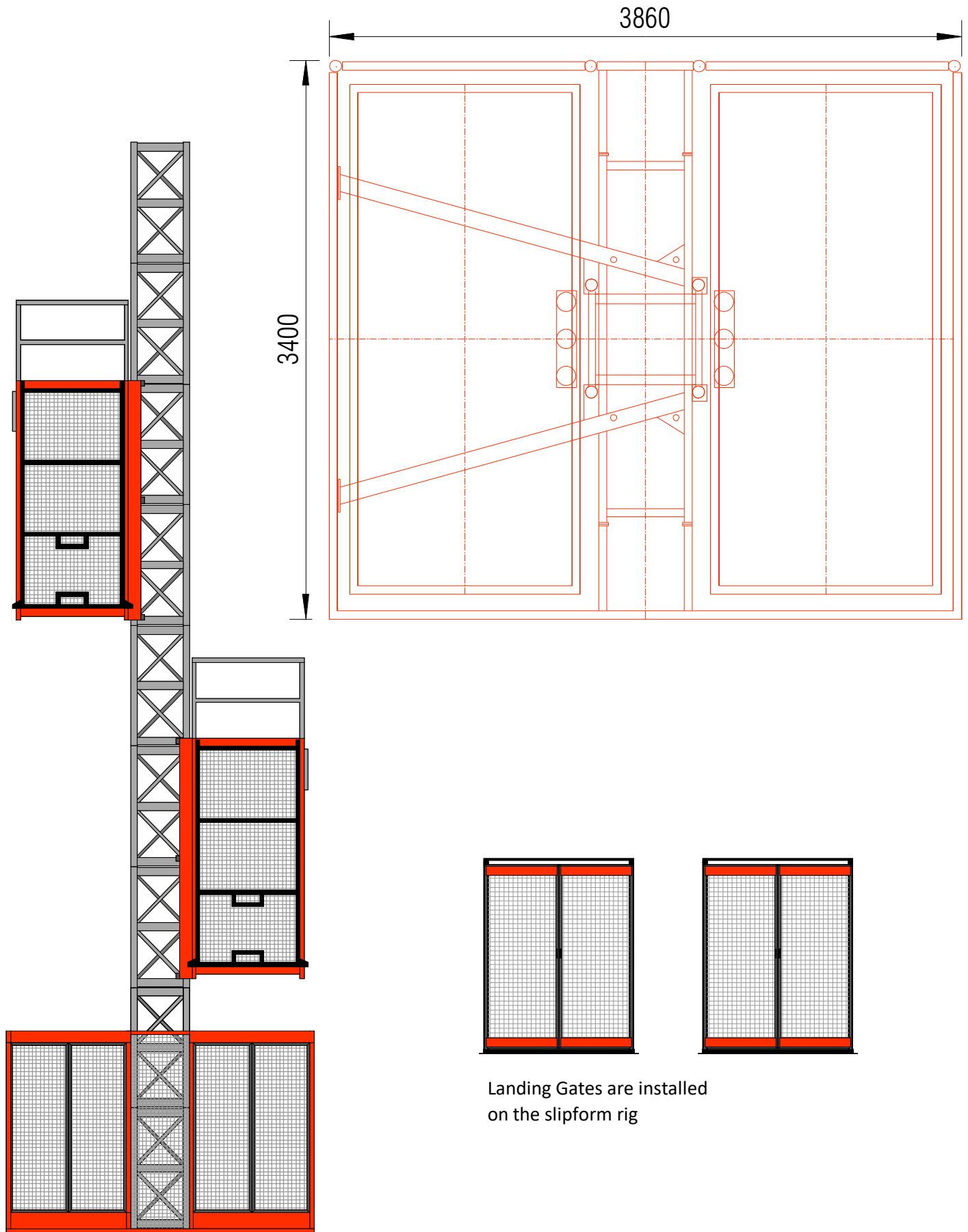

Landing Gates are installed on the slipform rig