

20/37 TD Passenger Goods Hoist

CAPITAL
HOIST

Alimak 20/27 TD Passenger Goods Hoist	
Capacity	2000kg per cage
Personnel	25 per cage
Internal Cage Dimensions L x W x H	3700 x 1500 x 2150
Cage Gate Opening H x W	2000 x 1490
Landing Gate Opening H x W	2000 x 1465
Base Unit Weight Single	3400kg
Base Unit Weight Twin	5340kg
Motor Drive Unit	3 x 9.5kW per cage
Power Fuse Supply (3-Phase)	80A per cage
Starting Current	300A per cage
Maximum Mast Height	150m
Max Tie Spacing	12m

Tel 01322 339 353

www.capitalhoists.co.uk

Info@caphoist.co.uk

17 Maypole Crescent
Darent Industrial Park
Erith
Kent
DA8 2JZ

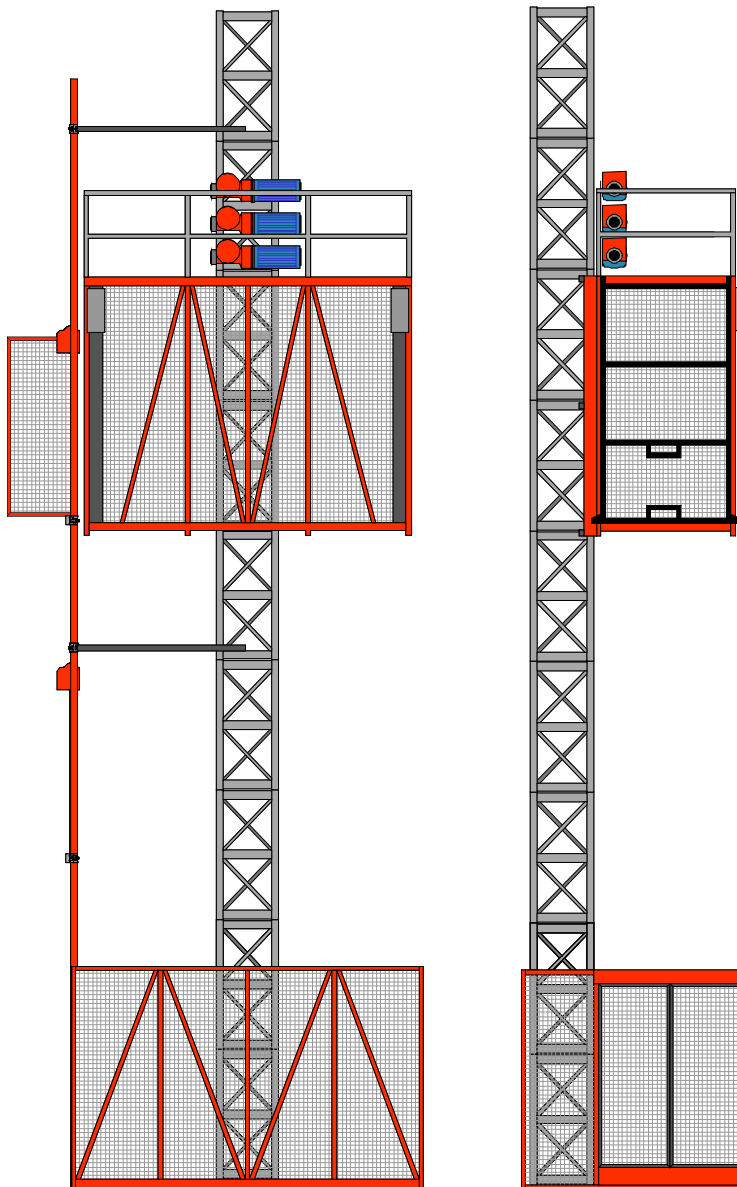
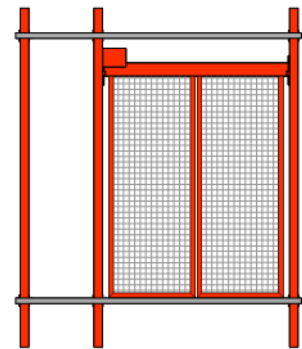

Landing Gates are supported
on the hoist superstructure

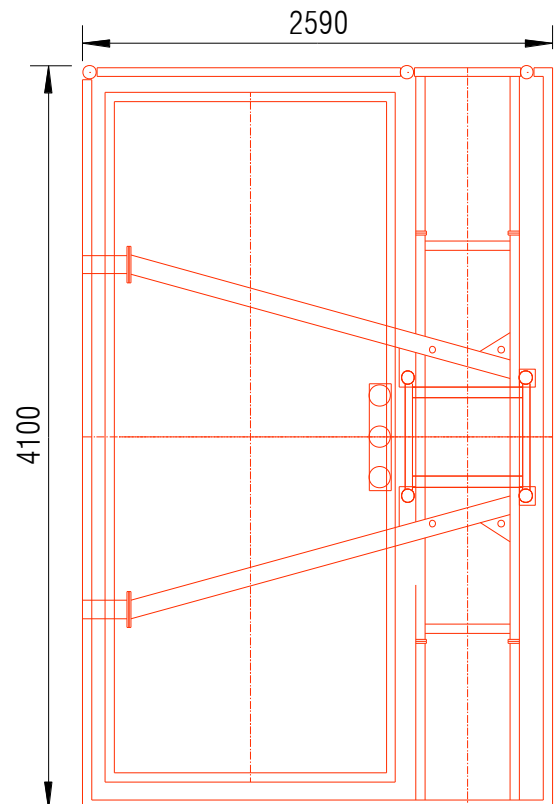

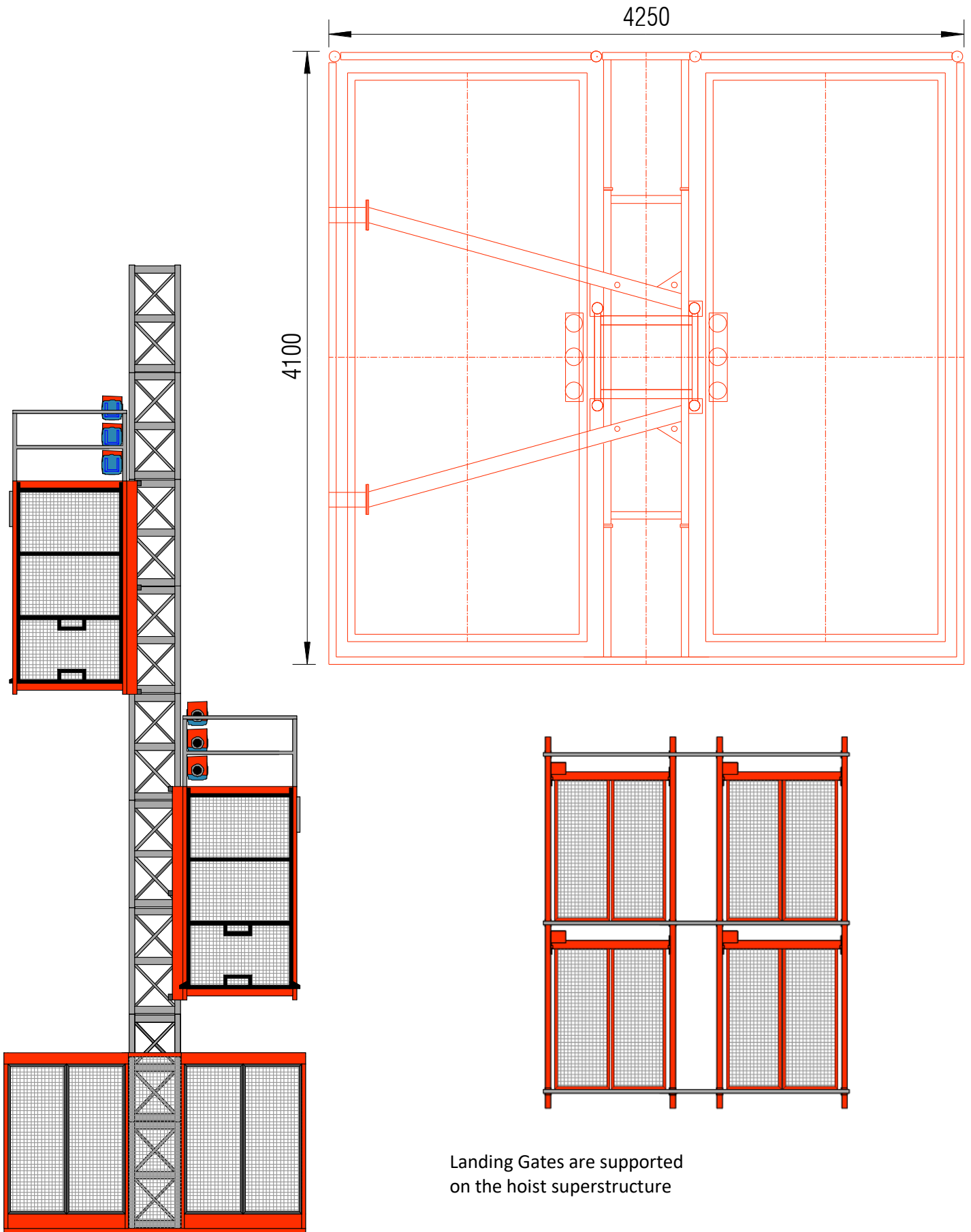

Landing Gates are supported on the hoist superstructure